



# HYGIENIC WALL INSTALLATION

## Installation Options

We are committed to providing exceptional workmanship and are teams are renowned for their quality of work. To ensure a quality installation, below are the different joining methods which can be used for all PVC hygienic cladding regardless of the brand.



PVC 'H-Trim' 2-Part

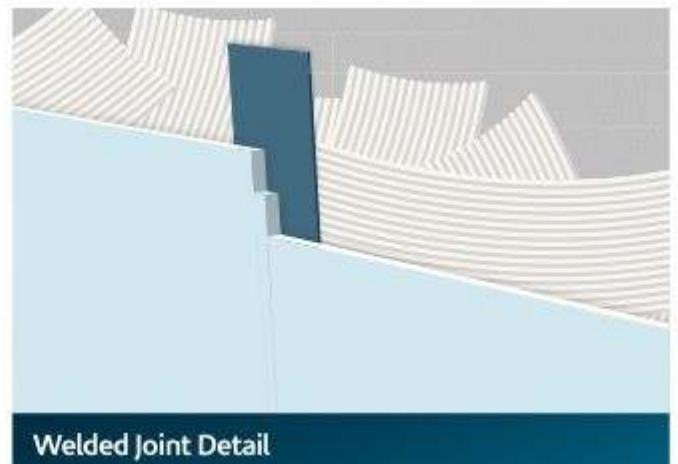

Welded Joint Detail



PVC 'J-Trim'

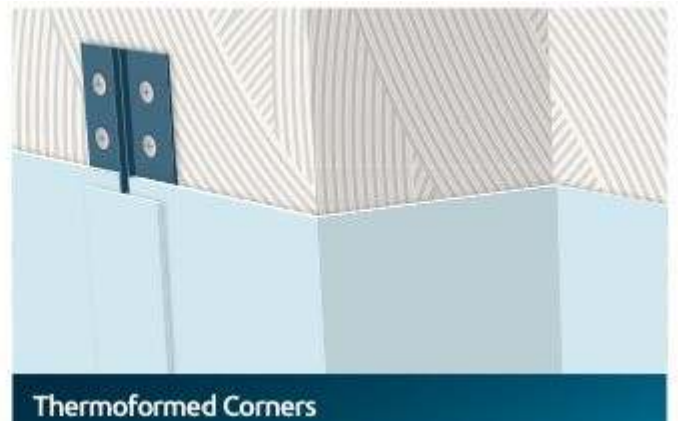

Thermoformed Corners



Vinyl Floor 2-Part Joint Detail



Vinyl Floor Overlay Detail